

ET Series PNP

Instruction manual



Feature

- * OV231 Camera, used OV solution and high definition.
- * The structure uses 2.5mm thick carbon fiber and Super prop protector cover, especially suitable for novice flying.
- * Product performance and wheelbase for indoor through the special design.
- * 4in1 10A 2S~3S AIO ESC support MULTISHOT, ONESHOT and DSHOT provides a better user experience.
- * Modular design, PIKO BLX FC, with the latest betaflyght firmware.

ET100 Configuration // // //



ET100 (Buzzer)

Wheelbase:100mm

Flytower20*20:

PIKO BLX(F303CC+MPU6000)

4in1 10A BLheliS

VTX:Q100 VTX(25mW/100mW 16CH)

Camera:OV231(800TVL 150° NTSC)

Motor:XT1103-7800KV

Prop:1935

Battery:7.4V 450mAh 80C

Weight:71.9g(without receiver and battery)

Receiver:FM800(Futaba),XM(Frsky),

FS-RX2A(Flysky),DSM2(Spektrum),RX800

ET100 Package list // // //

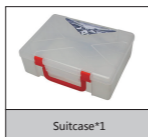

ET115 Configuration // // //

ET115 (Buzzer)

Wheelbase:115mm

Flytower20*20:

PIKO BLX(F303CC+MPU6000)

4in1 10A BLheliS

VTX:Q100 VTX(25mW/100mW 16CH)

Camera:OV231(800TVL 150° NTSC)

Motor:XT1104-7500KV

Prop:2345

Battery:7.4V 550mAh 80C

Weight:89.1g(without receiver and battery)

Receiver:FM800(Futaba),XM(Frsky),

FS-RX2A(Flysky),DSM2(Spektrum),RX800



ET115 Package list // // //

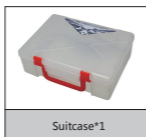

ET125 Configuration //



ET125 (Buzzer)

Wheelbase:125mm

Flytower20*20:

PIKO BLX(F303CC+MPU6000)

4in1 10A BLheliS

VTX:Q100 VTX(25mW/100mW 16CH)

Camera:OV231(800TVL 150° NTSC)

Motor:XT1104-7500KV

Prop:2840

Battery:7.4V 550mAh 80C

Weight:93.2g(without receiver and battery)

Receiver:FM800(Futaba),XM(Frsky),

FS-RX2A(Flysky),DSM2(Spektrum),RX800

ET125 Package list //

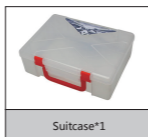

Installation drawing

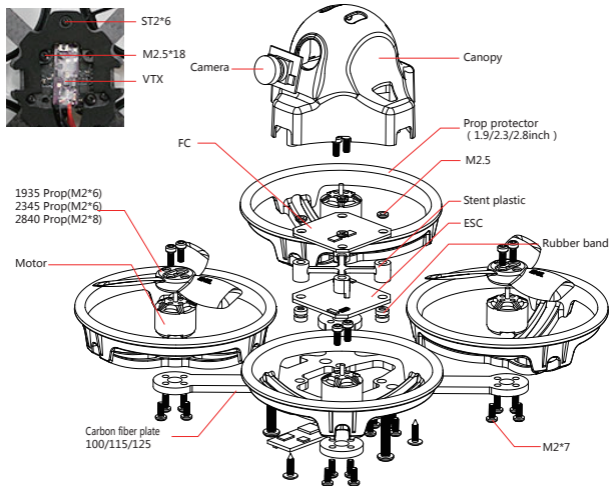

Camera



Pay attention to camera direction



Install OV231

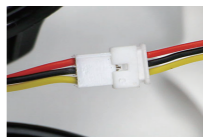

Connent OV231

Setting before

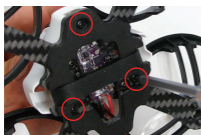

Open canopy



Connect USB

VTX **////**

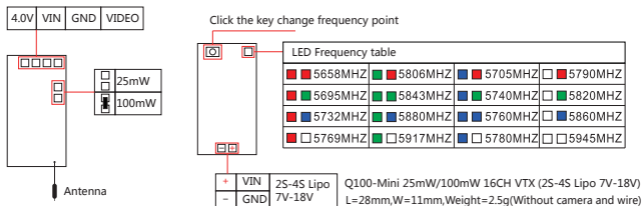

Please attention ventilation cooling

FC **////**

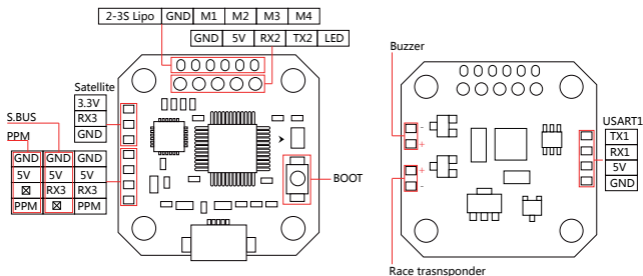

ESC **////**

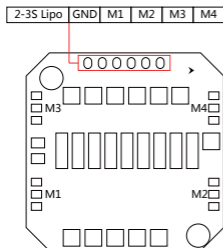

Motor **////**

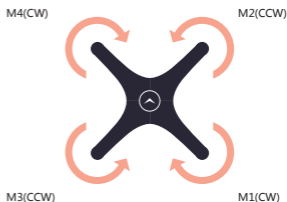

Note:pay attention to the direction of rotation of the motor when installing the prop

XM bind (default S.BUS),example(FRSKY X9D)

1. Open remote control, set D16 mode.
2. Hold receiver bind button to power, loosen until red and green light constant lighting.
3. Open remote control Bind, press "Enter" and wait a few seconds, then stop Bind when red light flash and green light constant lighting.
4. Disconnect receiver power and power-on again, green light constant lighting means bind success.

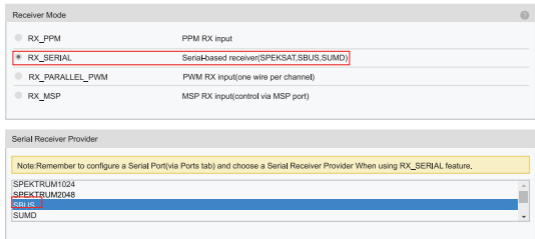
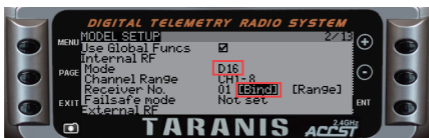

FS-RX2A bind (default PPM), example (FLYSKY FS-i6)

1. Hold receiver bind button to power, loosen until LED fast blink
2. Hold remote control Bind button and open the power supply.
3. Remote control enter bind mode, close the power supply.
4. Open the remote control power supply, LED light constant lighting means bind success

PPM mode to S.BUS mode

Note:

1. Remote control and receiver switch output mode under normal communication, long press bind button 2S to SBUS mode
2. Indicator light quick flashing twice and then put out 1S means success switch to SBUS mode

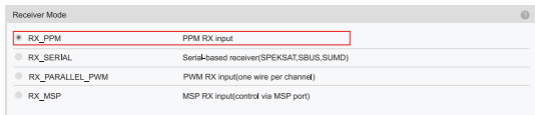

FM800 bind (default S.BUS, nonsupport PPM), example (FUTABA T8FG)

1. Open remote control, hold receiver bind button to power
2. Green light constant lighting means bind success

Note:

S.BUS and CPPM mode switch

Close remote control, press bind button 6S when red light flash, loosen until enter S,BUS and CPPM mode switch

1. Green light quick flashing, press bind button and disconnect power, power-on again, enter S,BUS mode
2. Green light slow flash, press bind button and disconnect power, power-on again, enter PPM mode

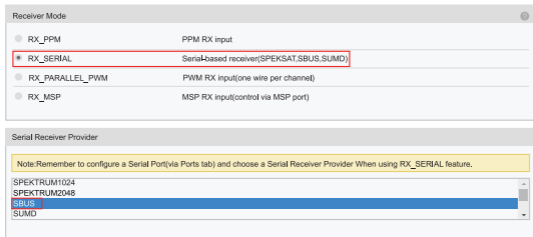
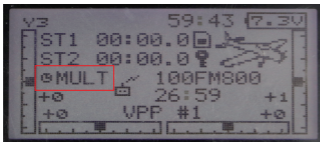

DSM bind, example (T-SIX)

1. Remote control in off state, bind button to power
2. Loosen until indicator light fast blink, enter to bind mode
3. Open remote control bind mode, indicator light constant lighting means bind success

Note 1:

DSM2 uses SPEKTRUM1024 or SPEKTRUM2048 protocol, according to the remote control model to choose corresponding serial port protocol (example T-SIX, set protocol as SPEKTRUM1024)

Note 2:

DSMX remote control bind to DSM2 and DSMX receiver, but DSM2 remote control only bind to DSM2 receiver.

DSM2: Old SPEKTRUM and JR remote control protocol, widely-used with good compatibility.

DSMX: Newest SPEKTRUM remote control protocol, DSMX backwards compatible DSM2.

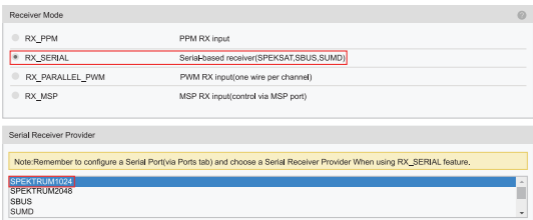

Product and Factory Code /////





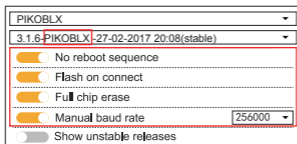

Name	Factory Code	Name	Factory Code
ET100 PNP NO RX	PNPET100.NO RX	ET125 KIT	KIT.ET125
ET100 PNP XM	PNPET100.XM	1935 Prop	PROP.1935.3.WHITE
ET100 PNP FM800	PNPET100.FM800	2345 Prop	PROP.2345.3.WHITE
ET100 PNP FS-RX2A	PNPET100.FS-RX2A	2840 Prop	PROP.2840.3.WHITE
ET100 PNP DSM2	PNPET100.DSM2	Battery 7.4V 450mAh 80C	BAT.7.4V 450MAH 80C
ET100 PNP RX800	PNPET100.RX800	Battery 7.4V 550mAh 80C	BAT.7.4V 550MAH 80C
ET100 KIT	KIT.ET100	Carbon fiber plate (ET100 Part)	PART.BOTTOM PLATE.ET100
ET115 PNP NO RX	PNPET115.NO RX	Carbon fiber plate (ET115 Part)	PART.BOTTOM PLATE.ET115
ET115 PNP XM	PNPET115.XM	Carbon fiber plate (ET125 Part)	PART.BOTTOM PLATE.ET125
ET115 PNP FM800	PNPET115.FM800	XT1103-7800KV	MOTOR.XT1103-7800KV
ET115 PNP FS-RX2A	PNPET115.FS-RX2A	XT1104-7500KV	MOTOR.XT1104-7500KV
ET115 PNP DSM2	PNPET115.DSM2	Flytower 20*20	FC+ESC.FLYTOWER20*20
ET115 PNP RX800	PNPET115.RX800	Flytower 20*20 ESC	ESC.FLYTOWER20*20
ET115 KIT	KIT.ET115	Flytower 20*20 FC	FC.FLYTOWER20*20
ET125 PNP NO RX	PNPET125.NO RX	ET Canopy	PART.ET CANOPY
ET125 PNP XM	PNPET125.XM	OV231	CAM.OV231
ET125 PNP FM800	PNPET125.FM800	Q100 VTX	VTX.Q100
ET125 PNP FS-RX2A	PNPET125.FS-RX2A	1.9 inch black propeller protector (all surround)	PART.1.9 PROTERTOR ALL BLACK
ET125 PNP DSM2	PNPET125.DSM2	2.3 inch black propeller protector (all surround)	PART.2.3 PROTERTOR ALL BLACK
ET125 PNP RX800	PNPET125.RX800	2.8 inch black propeller protector (all surround)	PART.2.8 PROTERTOR ALL BLACK

Firmware update /////

BETAFLIGHT firmware already flash before leave the factory,user just need connect PC to adjust the parameter.

- 1.Open betafight configurator , then click ,select FW version



- 2.Click , then click  to download FW to FC,
click  after FW updating finish into settings menu.
- 3.LED setting,select , then open  LED_STRIP
- 4.Buzzer setting,select , then open  VBAT

5.Default setting of receiver is 5th channel ARM,6th channel mode switching.

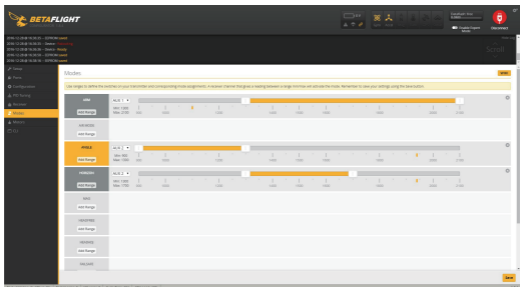

6.PID Default setting

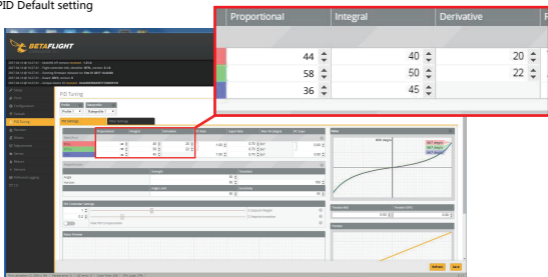

After sale service *////*

- 1.Provide free reparation service when find the product defect after purchase.
- 2.Provide pay-needed reparation service when product damage because improper operation.
- 3.China customers please contact with the after-sales service,overseas client please contact the dealer.

PNP/RTF Test report ID :

- Flight test
- Transmitter functions properly
 - Flying in good condition
 - Camera OK
 - VTX OK

- Package check
- PNP
 - RTF
 - Frame
 - Transmitter
 - ID is the same
 - All parts of the installation
 - Insulating sleeves have been installed manual
 - Complete accessories,total ___packages

QC: _____

QC: _____