

Lighting diagram

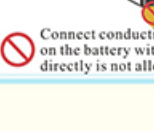

Tips

1. Color picture on the outer packing is final finishing picture, pls follow it to manufacture.
2. Pls prepare tools, like scissors, straightedge, screwdriver and ect.
3. Pls cut material according to template to avoid mistake.
4. Small deviation among different batch of wood material, cloth and beads is inevitable, pls understand.
5. Children should be accompanied by adults to manufacture.
6. Refer to below operation to test if the bulbs work or not.



Connect conducting wire on the battery with hand directly is not allowed.

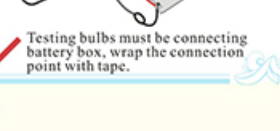

Testing bulbs must be connecting battery box, wrap the connection point with tape.

1

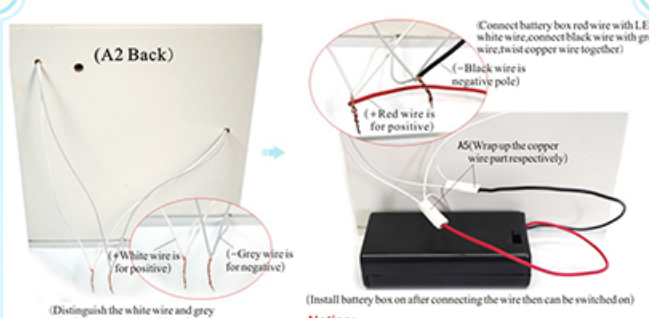

Final assembly

- Stick the completed articles on the relative place according to color drawing.



14

C Package

(Unit:CM)

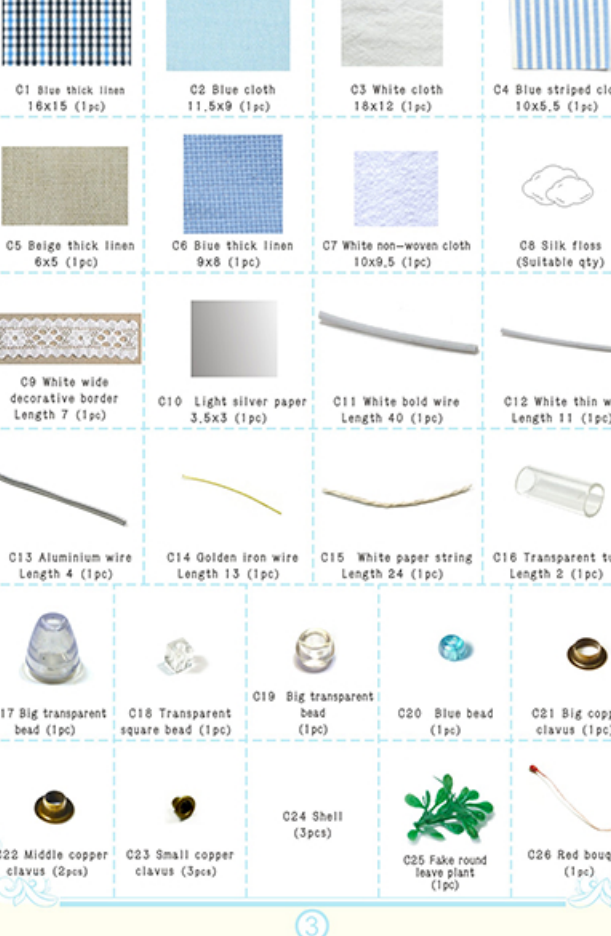

3



Lamps

- Follow below photo instruction to complete two lamps.



12

Decorative pictures

- Cut out below photo paper according to the relative size on cutting place, complete decoration painting.



5

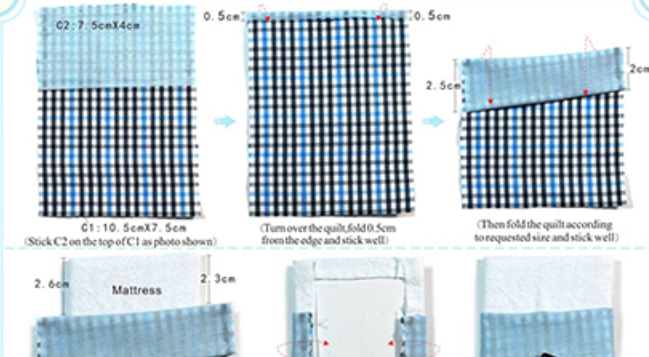

11

Box

- Follow below steps to do the cutting, sticking and manufacture to complete the box.

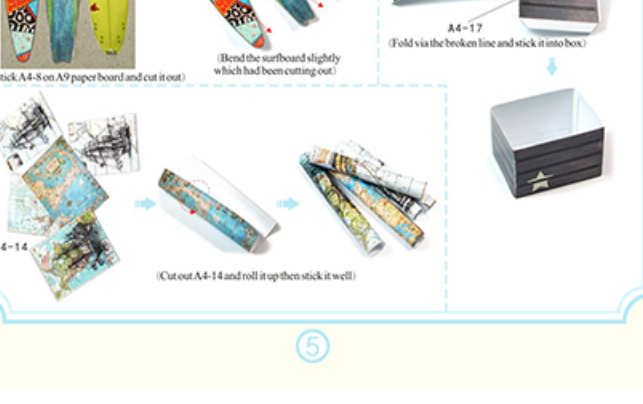

5

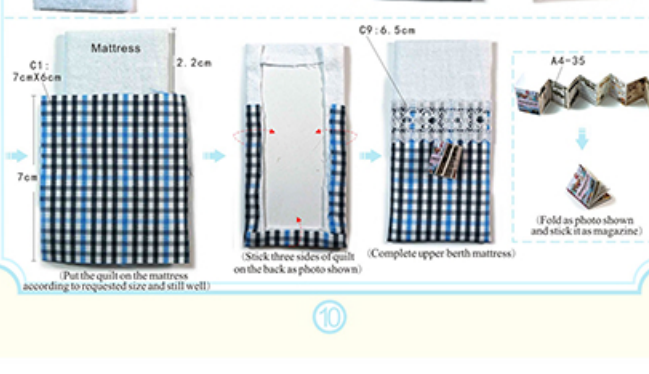

10

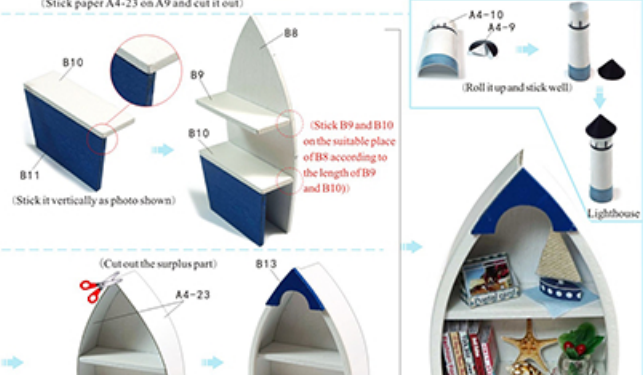

7

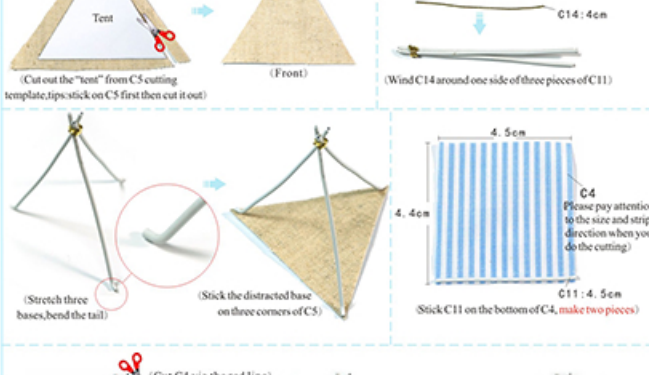

8



9



8

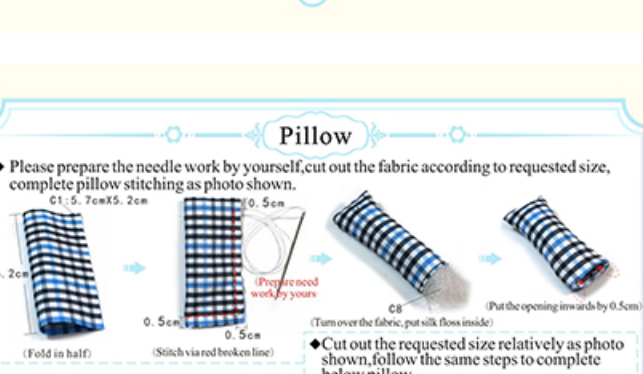

9



8



11



8

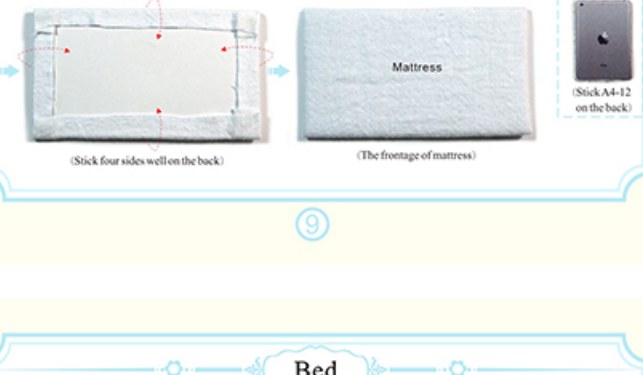

11



8

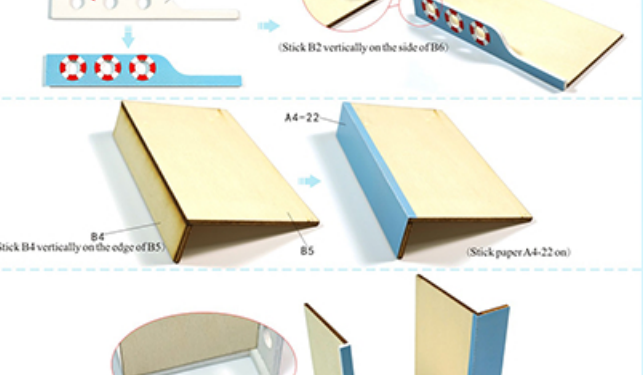

11

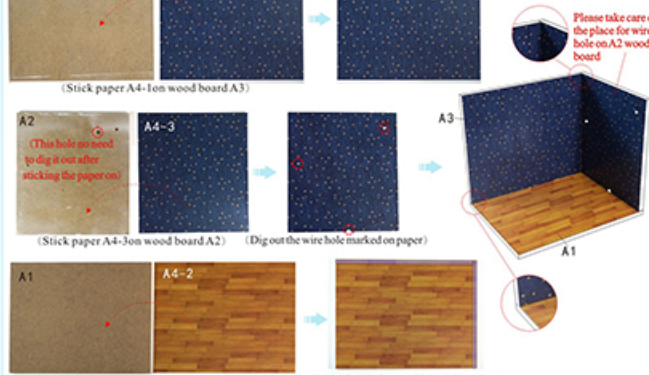

8

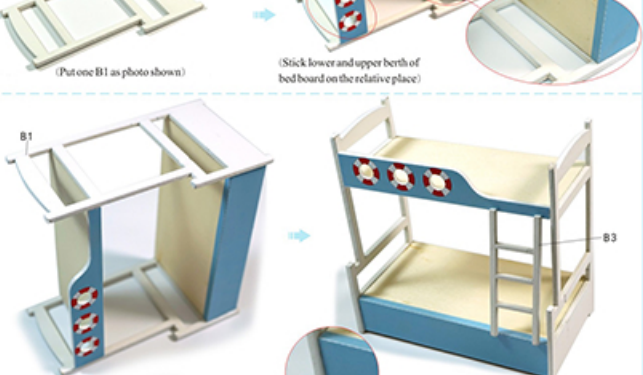

11



8

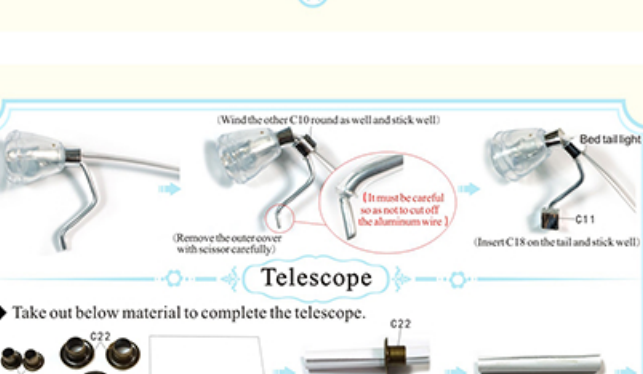

11

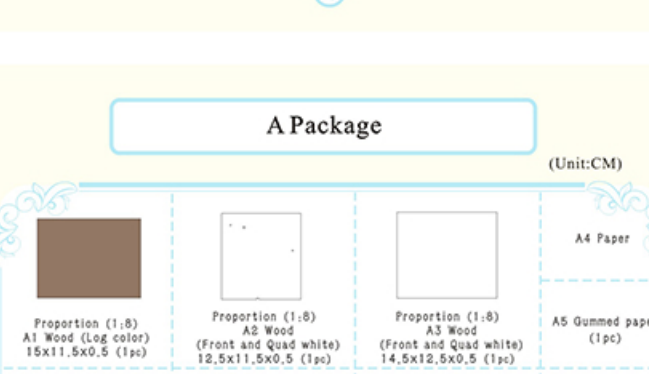

8



11

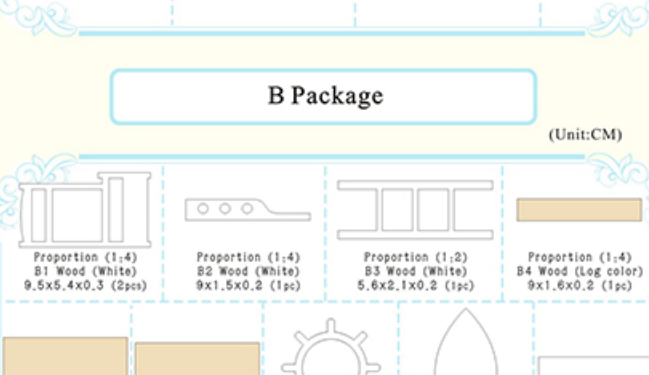

8



11



8

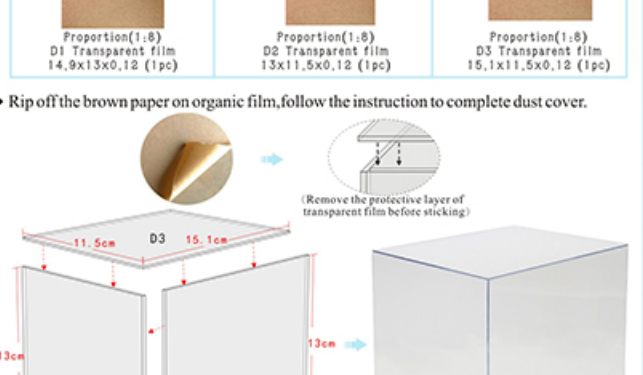

11



8



15



8



15



8



15



8

15

8

15

8

15

8

15

8

15

8

15

8

15

8

15

8

15

8

15

8

15

8

15

8

15

8

15

8

15

8

15

8

15

8

15

8

15

8

15

8

15

8

15

8

15

8

15

8

15

8

15

8

15

8

15

8

15

8

15

8

15

8

15

8

15

8

15

8

15

8

15

8

15

8

15

